

DCL-MZZ Subminiature Multi-turn type Electric Actuator

- Super mini volume (Smaller than a cola tin)
- Large torque (18Nm/5r/min)
- Adopted Brushless motor
- Torque closes valve and highly sealed in close position

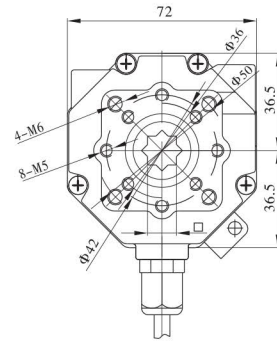

Overall Dimension Drawings

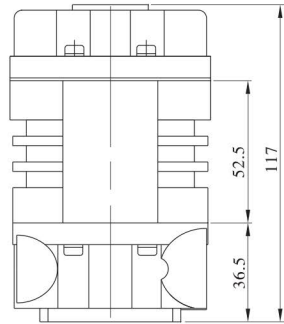

Square	9×9 、 11×11
Flange	F03、F04、F05
Valve Stem	Height ≤ 16 mm

Performance Parameters

Parameters	Type	DCL-MZZ
Power		DC24V
Motor Power		20W
Rated Current		1.1A
Standard Time/Torque		18Nm
Optional Time/Torque		
Turning Angle		3r
Total Weight		1.2Kg
Insulating Resistance		100M Ω /250VDC
Withstand Voltage Class		500VAC 1minute
Protection Class		IP67
Installation Angle		360° at any angle
Electric Interface		7-core cable for connection
Ambient Temperature		-25°C ~ +55°C
Fuse		2A

Control Circuit

